

塑料外壳双面金属化聚丙烯膜电容器 Double sided metallized polypropylene film capacitor (Box-type)

■ 外形图 Outline Drawing

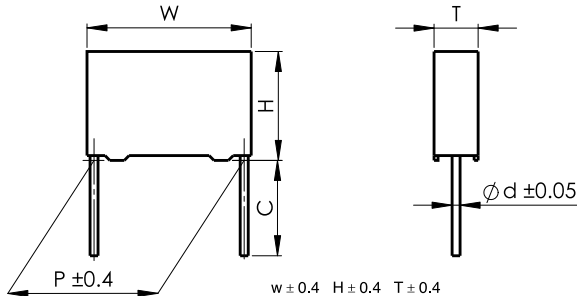

■ 特点

- 双面金属化聚丙烯膜
- 损耗小，内部温升小
- 负电容量温度系数
- 优异的阻燃性能

■ 主要用途

- 高压高频脉冲电路中
- 电子照明（汽车头灯、镇流器）

■ 技术要求 Specifications

■ Features

- Doublesided metallized polypropylene film
- Low loss and small inherent temperature rise
- Negative temperature coefficient of capacitance
- Excellent active and passive flame resistant abilities

■ Typical Applications

- Pulse applications with high. AC. voltage and HIGH current
- Electronic lighting(i.e. car headlamp and lighting ballast)

引用标准 Reference Standard	GB/T 14579(IEC 60384-17)				
气候类别 Climatic Category	40/105/56				
额定温度 Rated Temperature	85℃				
工作温度 Operating Temperature Range	-40℃ ~105℃ (+85℃ to +105℃: decreasing factor 1.25% per °C for UR (dc)) (+75℃ to +105℃: decreasing factor 1.35% per °C for UR (ac))				
额定电压 Rated Voltage	250Vac (630Vdc) , 300Vac (800Vdc) 400Vac (1 000Vdc) , 500Vac (1 600Vdc) 700Vac (2 000Vdc) , 900Vac (2 500Vdc)				
电容量范围 Capacitance Range	0.0010μF ~ 0.12μF				
电容量偏差 Capacitance Tolerance	± 2%(G), ± 3% (H), ± 3.5%(C), ± 5% (J), ± 10%(K), ± 20% (M)				
耐电压 Voltage Proof	1.6UR (5s)				
损耗角正切 Dissipation Factor	≤ 10 × 10 ⁻⁴ (1kHz, 20℃)				
绝缘电阻 Insulation Resistance	≥ 100 000MΩ (20℃ ,100V, 1min)				
最大脉冲爬升速率 Maximum Pulse Rise Time(dV/dt): 若实际工作电压 U 比额定电压 UR 低, 电容器可工作在更高的 dV/dt 场合, 这样 dv/dt 允许值应为右表值乘以 UR/U。 If the working voltage(U) is lower than the rated voltage(UR), the capacitor can be worked at a higher dV/dt. In this case, the maximum allowed dV/dt is obtain by multiplying the right value with UR/U.	UR(V)	dV/dt (V/μs)			
		P=10.0	P=15.0	P=22.5	P=27.5
	250(630Vdc)	3 000	1 100	—	—
	300(800Vdc)	—	2 500	1 500	—
	400(1 000Vdc)	—	3 500	2 100	—
	500(1 600Vdc)	—	5 000	3 000	2 000
	700(2 000Vdc)	—	8 000	5 000	2 200
900(2 500Vdc)	—	—	7 000	—	



产品编码说明 Part number system

■ 18位产品代码如下：

The 18 digits part number is formed as follow:

1	2	3	4	5	6	7	8	9	10	11	12	13	14	15	16	17	18
C	8	4															

第1~3位	型号代码 C84= MMKP84	Digit 1 to 3	Series code C84= MMKP84
第4~5位	交流额定电压 E2=250V Q1=300V G2=400V H2=500V V1=700V X1=900V	Digit 4 to 5	AC rated voltage E2=250V Q1=300V G2=400V H2=500V V1=700V X1=900V
第6~8位	标称容量 举例：103=10 × 10 ³ pF=0.01μF	Digit 6 to 8	Rated capacitance value For example: 103=10 × 10 ³ pF=0.01μF
第9位	容量偏差 G= ± 2%,H = ± 3%,J= ± 5% K= ± 10%, M= ± 20%	Digit 9	Capacitance tolerance G= ± 2%,H = ± 3%,J= ± 5% K= ± 10%, M= ± 20%
第10位	引线脚距P 4=10.0mm 6=15.0mm 9=22.5mm B=27.5mm	Digit 10	Pitch 4=10.0mm 6=15.0mm 9=22.5mm B=27.5mm
第11位	内部特征码	Digit 11	Internal use
第12~15位	引线加工和包装代码	Digit 12 to 15	Lead form and packaging code
第16~18位	内部特征码	Digit 16 to 18	Internal use

■ **Table 1 引线加工和包装代码 lead form and packaging code**

第 12 位 Digit 12		第 13 位 Digit 13		第 14 位 Digit 14		第 15 位 Digit 15	
代码 Code	说明 explanation	代码 Code	说明 explanation	代码 Code	说明 explanation	代码 Code	说明 explanation
A	弹带包装 ammo-pack	4 6	F=10.0mm F=15.0mm	0	表示直脚 straight	5	P3=25.4mm;H=18.5mm (For pitch=10/15mm) (Detail parameter refer to pag 17)
C	直脚 straight lead “C” in the figure above	代码 Code	说明 explanation			0	引线长度偏差 ± 0.5mm 或标准长度 Length tolerance ± 0.5mm Or standard length
		00	标准的引线长度 (18mm ~ 26mm) standard lead length				
		45	引线长度 4.5mm lead length 4.5mm				

■ 外形尺寸 Dimensions (mm)

250Vac (630Vdc)						
C _N (μF)	W	H	T	P	d	Part number
0.010	13.0	9.0	4.0	10.0	0.6	C84E2103-40****+
0.012	13.0	9.0	4.0	10.0	0.6	C84E2123-40****+
0.015	13.0	11.0	5.0	10.0	0.6	C84E2153-40****+
0.018	13.0	12.0	6.0	10.0	0.6	C84E2183-40****+
0.022	13.0	12.0	6.0	10.0	0.6	C84E2223-40****+
0.027	17.5	12.0	6.0	15.0	0.8	C84E2273-60****+
0.033	17.5	12.0	6.0	15.0	0.8	C84E2333-60****+
0.039	17.5	12.0	6.0	15.0	0.8	C84E2393-60****+
0.047	17.5	13.5	7.5	15.0	0.8	C84E2473-60****+
0.056	17.5	13.5	7.5	15.0	0.8	C84E2563-60****+
0.068	17.5	14.5	8.5	15.0	0.8	C84E2683-60****+
0.082	17.5	16.0	10.0	15.0	0.8	C84E2823-60****+
0.10	17.5	16.0	10.0	15.0	0.8	C84E2104-60****+

300Vac (800Vdc)						
C _N (μF)	W	H	T	P	d	Part number
0.010	17.5	11.0	5.0	15.0	0.8	C84Q1103-60****+
0.012	17.5	11.0	5.0	15.0	0.8	C84Q1123-60****+
0.015	17.5	11.0	5.0	15.0	0.8	C84Q1153-60****+
0.018	17.5	11.0	5.0	15.0	0.8	C84Q1183-60****+
0.022	17.5	12.0	6.0	15.0	0.8	C84Q1223-60****+
0.027	17.5	12.0	6.0	15.0	0.8	C84Q1273-60****+
0.033	17.5	13.5	7.5	15.0	0.8	C84Q1333-60****+
0.039	17.5	13.5	7.5	15.0	0.8	C84Q1393-60****+
0.047	17.5	14.5	8.5	15.0	0.8	C84Q1473-60****+
0.056	17.5	16.0	10.0	15.0	0.8	C84Q1563-60****+
0.068	17.5	16.0	10.0	15.0	0.8	C84Q1683-60****+
0.056	26.5	15.0	6.0	22.5	0.8	C84Q1563-90****+
0.068	26.5	16.0	7.0	22.5	0.8	C84Q1683-90****+
0.082	26.5	17.0	8.5	22.5	0.8	C84Q1823-90****+
0.10	26.5	17.0	8.5	22.5	0.8	C84Q1104-90****+

400Vac (1 000Vdc)						
C _N (μF)	W	H	T	P	d	Part number
0.0056	17.5	11.0	5.0	15.0	0.8	C84G2562-60****+
0.0068	17.5	11.0	5.0	15.0	0.8	C84G2682-60****+
0.0082	17.5	11.0	5.0	15.0	0.8	C84G2822-60****+
0.010	17.5	12.0	6.0	15.0	0.8	C84G2103-60****+
0.012	17.5	12.0	6.0	15.0	0.8	C84G2123-60****+
0.015	17.5	13.5	7.5	15.0	0.8	C84G2153-60****+
0.018	17.5	13.5	7.5	15.0	0.8	C84G2183-60****+
0.022	17.5	14.5	8.5	15.0	0.8	C84G2223-60****+
0.027	17.5	16.0	10.0	15.0	0.8	C84G2273-60****+
0.033	17.5	16.0	10.0	15.0	0.8	C84G2333-60****+
0.027	26.5	15.0	6.0	22.5	0.8	C84G2273-90****+
0.033	26.5	16.0	7.0	22.5	0.8	C84G2333-90****+
0.039	26.5	16.0	7.0	22.5	0.8	C84G2393-90****+
0.047	26.5	17.0	8.5	22.5	0.8	C84G2473-90****+
0.056	26.5	17.0	8.5	22.5	0.8	C84G2563-90****+
0.068	26.5	18.5	10.0	22.5	0.8	C84G2683-90****+
0.082	26.5	18.5	10.0	22.5	0.8	C84G2823-90****+
0.10	26.5	22.0	12.0	22.5	0.8	C84G2104-90****+

500Vac (1 600Vdc)						
C _N (μF)	W	H	T	P	d	Part number
0.0010	17.5	11.0	5.0	15.0	0.8	C84H2102-60****+
0.0012	17.5	11.0	5.0	15.0	0.8	C84H2122-60****+
0.0015	17.5	11.0	5.0	15.0	0.8	C84H2152-60****+
0.0018	17.5	11.0	5.0	15.0	0.8	C84H2182-60****+
0.0022	17.5	11.0	5.0	15.0	0.8	C84H2222-60****+
0.0027	17.5	11.0	5.0	15.0	0.8	C84H2272-60****+
0.0033	17.5	11.0	5.0	15.0	0.8	C84H2332-60****+
0.0039	17.5	11.0	5.0	15.0	0.8	C84H2392-60****+
0.0047	17.5	11.0	5.0	15.0	0.8	C84H2472-60****+
0.0056	17.5	11.0	5.0	15.0	0.8	C84H2562-60****+
0.0068	17.5	12.0	6.0	15.0	0.8	C84H2682-60****+
0.0082	17.5	12.0	6.0	15.0	0.8	C84H2822-60****+
0.010	17.5	13.5	7.5	15.0	0.8	C84H2103-60****+
0.012	17.5	13.5	7.5	15.0	0.8	C84H2123-60****+
0.015	17.5	14.5	8.5	15.0	0.8	C84H2153-60****+
0.018	17.5	16.0	10.0	15.0	0.8	C84H2183-60****+
0.022	17.5	16.0	10.0	15.0	0.8	C84H2223-60****+
0.018	26.5	15.0	6.0	22.5	0.8	C84H2183-90****+
0.022	26.5	16.0	7.0	22.5	0.8	C84H2223-90****+
0.027	26.5	16.0	7.0	22.5	0.8	C84H2273-90****+
0.033	26.5	17.0	8.5	22.5	0.8	C84H2333-90****+
0.039	26.5	18.5	10.0	22.5	0.8	C84H2393-90****+
0.047	26.5	18.5	10.0	22.5	0.8	C84H2473-90****+
0.056	26.5	22.0	12.0	22.5	0.8	C84H2563-90****+
0.068	32.0	20.0	11.0	27.5	0.8	C84H2683-B0****+
0.082	32.0	20.0	11.0	27.5	0.8	C84H2823-B0****+
0.10	32.0	22.0	13.0	27.5	0.8	C84H2104-B0****+

700Vac (2 000Vdc)						
C _N (μF)	W	H	T	P	d	Part number
0.00051	17.5	11.0	5.0	15.0	0.8	C84V1511-60****+
0.00068	17.5	11.0	5.0	15.0	0.8	C84V1681-60****+
0.0010	17.5	11.0	5.0	15.0	0.8	C84V1102-60****+
0.0012	17.5	11.0	5.0	15.0	0.8	C84V1122-60****+
0.0015	17.5	11.0	5.0	15.0	0.8	C84V1152-60****+
0.0018	17.5	11.0	5.0	15.0	0.8	C84V1182-60****+
0.0022	17.5	11.0	5.0	15.0	0.8	C84V1222-60****+
0.0027	17.5	12.0	6.0	15.0	0.8	C84V1272-60****+
0.0033	17.5	12.0	6.0	15.0	0.8	C84V1332-60****+
0.0039	17.5	13.5	7.5	15.0	0.8	C84V1392-60****+
0.0047	17.5	13.5	7.5	15.0	0.8	C84V1472-60****+
0.0056	17.5	14.5	8.5	15.0	0.8	C84V1562-60****+
0.0068	17.5	14.5	8.5	15.0	0.8	C84V1682-60****+
0.0082	17.5	16.0	10.0	15.0	0.8	C84V1822-60****+
0.010	17.5	16.0	10.0	15.0	0.8	C84V1103-60****+
0.0068	26.5	15.0	6.0	22.5	0.8	C84V1682-90****+
0.0082	26.5	15.0	6.0	22.5	0.8	C84V1822-90****+
0.010	26.5	15.0	6.0	22.5	0.8	C84V1103-90****+
0.012	26.5	16.0	7.0	22.5	0.8	C84V1123-90****+
0.015	26.5	17.0	8.5	22.5	0.8	C84V1153-90****+
0.018	26.5	18.5	10.0	22.5	0.8	C84V1183-90****+
0.022	26.5	18.5	10.0	22.5	0.8	C84V1223-90****+
0.027	26.5	22.0	12.0	22.5	0.8	C84V1273-90****+
0.033	26.5	22.0	12.0	22.5	0.8	C84V1333-90****+
0.018	32.0	18.0	9.0	27.5	0.8	C84V1183-B0****+
0.022	32.0	18.0	9.0	27.5	0.8	C84V1223-B0****+
0.027	32.0	18.0	9.0	27.5	0.8	C84V1273-B0****+
0.033	32.0	20.0	11.0	27.5	0.8	C84V1333-B0****+
0.039	32.0	20.0	11.0	27.5	0.8	C84V1393-B0****+
0.047	32.0	22.0	13.0	27.5	0.8	C84V1473-B0****+
0.056	32.0	22.0	13.0	27.5	0.8	C84V1563-B0****+
0.068	32.0	24.5	15.0	27.5	0.8	C84V1683-B0****+
0.082	32.0	28.0	14.0	27.5	0.8	C84V1823-B0****+
0.10	32.0	33.0	18.0	27.5	0.8	C84V1104-B0****+
0.12	32.0	33.0	18.0	27.5	0.8	C84V1124-B0****+

900Vac (2 500Vdc)						
C _N (μF)	W	H	T	P	d	Part number
0.0010	26.5	15.0	6.0	22.5	0.8	C84X1102-90****+
0.0012	26.5	15.0	6.0	22.5	0.8	C84X1122-90****+
0.0015	26.5	15.0	6.0	22.5	0.8	C84X1152-90****+
0.0018	26.5	15.0	6.0	22.5	0.8	C84X1182-90****+
0.0022	26.5	15.0	6.0	22.5	0.8	C84X1222-90****+
0.0027	26.5	15.0	6.0	22.5	0.8	C84X1272-90****+
0.0033	26.5	15.0	6.0	22.5	0.8	C84X1332-90****+
0.0039	26.5	15.0	6.0	22.5	0.8	C84X1392-90****+
0.0047	26.5	15.0	6.0	22.5	0.8	C84X1472-90****+
0.0056	26.5	15.0	6.0	22.5	0.8	C84X1562-90****+
0.0068	26.5	16.0	7.0	22.5	0.8	C84X1682-90****+
0.0082	26.5	16.0	7.0	22.5	0.8	C84X1822-90****+
0.010	26.5	17.0	8.5	22.5	0.8	C84X1103-90****+
0.012	26.5	18.5	10.0	22.5	0.8	C84X1123-90****+
0.015	26.5	18.5	10.0	22.5	0.8	C84X1153-90****+
0.018	26.5	22.0	12.0	22.5	0.8	C84X1183-90****+
0.022	26.5	22.0	12.0	22.5	0.8	C84X1223-90****+

备注: 1. “-”表示容量偏差。 “-”=capacitance tolerance code, M=±20%,K=±10%,J=±5%,H=±3%,G=±2%
2. “****”表示引线加工和包装代码(见table 1)。“****”=lead form and packing code (refer to table 1)