

Chip Inductor AWHH Series

**Automotive
AEC-Q200**

RoHS Compliant
Halogen Free
REACH Compliant



- RF
Circuit
- Unshield
- Wire
Wound
- Ceramic
- High
Q

Part Numbering

| | | | | | | |
|-------|-------------|--------------|-------------------------|--------------------|----------------|---------------|
| A | WHH | 00 | 161108 | 10N | H | 00 |
| Grade | Series Name | Control Code | Dimensions Code (mm) | Inductance (nH) | Tolerance | Internal Code |
| | | | 161108 1.6x1.12x0.82 | 3N3 3.3 10N 10 | H ±3% J ±5% | |

Chip Inductor AWHH Series

**Automotive
AEC-Q200**

AWHH00161108 Type

■ Dimensions

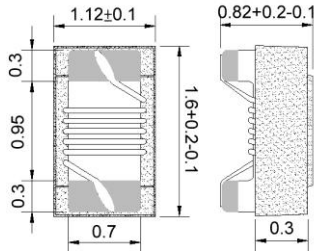

unit:mm

■ Recommended Land Pattern

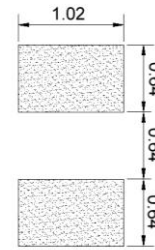

unit:mm

■ Electrical Characteristics

| Part No. | Inductance (nH) | L/Q Test | | Q Typ. | SRF (GHz)Typ. | RDC (Ω)Max. | I _{rms} (mA)Max. | Tolerance |
|--------------------|-----------------|-------------|--|--------|---------------|-------------|---------------------------|-----------|
| | | Freq. (MHz) | | | | | | |
| AWHH001611083N3□00 | 3.3 | 250/250 | | 36 | 9.6 | 0.034 | 1900 | 5,3 |
| AWHH001611083N6□00 | 3.6 | 250/250 | | 28 | 9.7 | 0.04 | 1900 | 5,3 |
| AWHH001611085N1□00 | 5.1 | 250/250 | | 38 | 8.9 | 0.042 | 1700 | 5,3 |
| AWHH001611085N6□00 | 5.6 | 250/250 | | 35 | 6.6 | 0.042 | 1700 | 5,3 |
| AWHH001611086N0□00 | 6 | 250/250 | | 49 | 6 | 0.042 | 1700 | 5,3 |
| AWHH001611088N2□00 | 8.2 | 250/250 | | 40 | 5.9 | 0.054 | 1400 | 5,3 |
| AWHH001611088N7□00 | 8.7 | 250/250 | | 46 | 5.5 | 0.054 | 1400 | 5,3 |
| AWHH001611089N1□00 | 9.1 | 250/250 | | 40 | 5.1 | 0.052 | 1400 | 5,3 |
| AWHH001611089N5□00 | 9.5 | 250/250 | | 42 | 4.9 | 0.054 | 1400 | 5,3 |
| AWHH0016110810N□00 | 10 | 250/250 | | 44 | 4.3 | 0.054 | 1400 | 5,3 |
| AWHH0016110812N□00 | 12 | 250/250 | | 40 | 4.1 | 0.088 | 1100 | 5,3 |
| AWHH0016110818N□00 | 18 | 250/250 | | 45 | 3.3 | 0.082 | 1200 | 5,3 |

Note: When ordering, please specify tolerance code. Tolerance: H=±3% / J=±5%

1. Operating temperature range - 40°C ~ 125°C(Including self - temperature rise)
2. I_{rms} for a 15°C temperature rise from 25°C ambient.
3. Measure Equipment:
 L & Q: Agilent E4991A+Agilent HP16197A
 SRF: Agilent E5071C
 RDC: Chroma 16502
 I_{rms}: HP4284A+HP42841A/HP4285A+HP42841A

AWHH00161108 Type

■ Characteristics Graph

Inductance vs. Frequency Characteristics

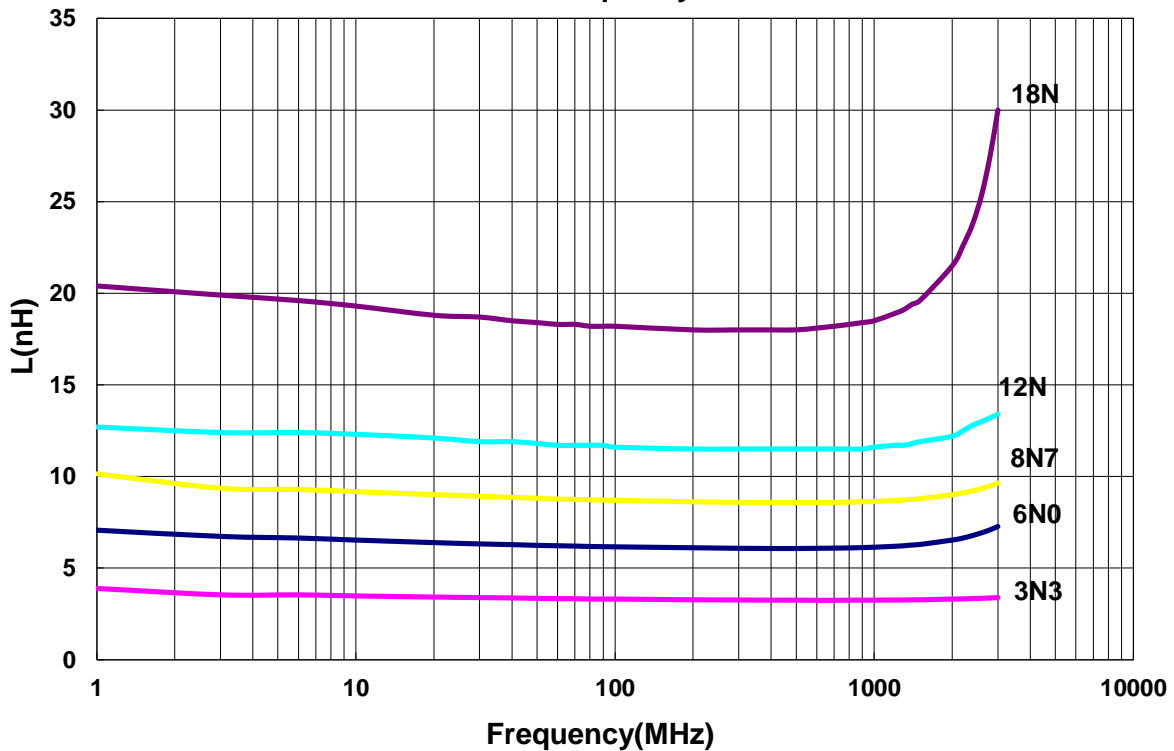

Q vs. Frequency Characteristics

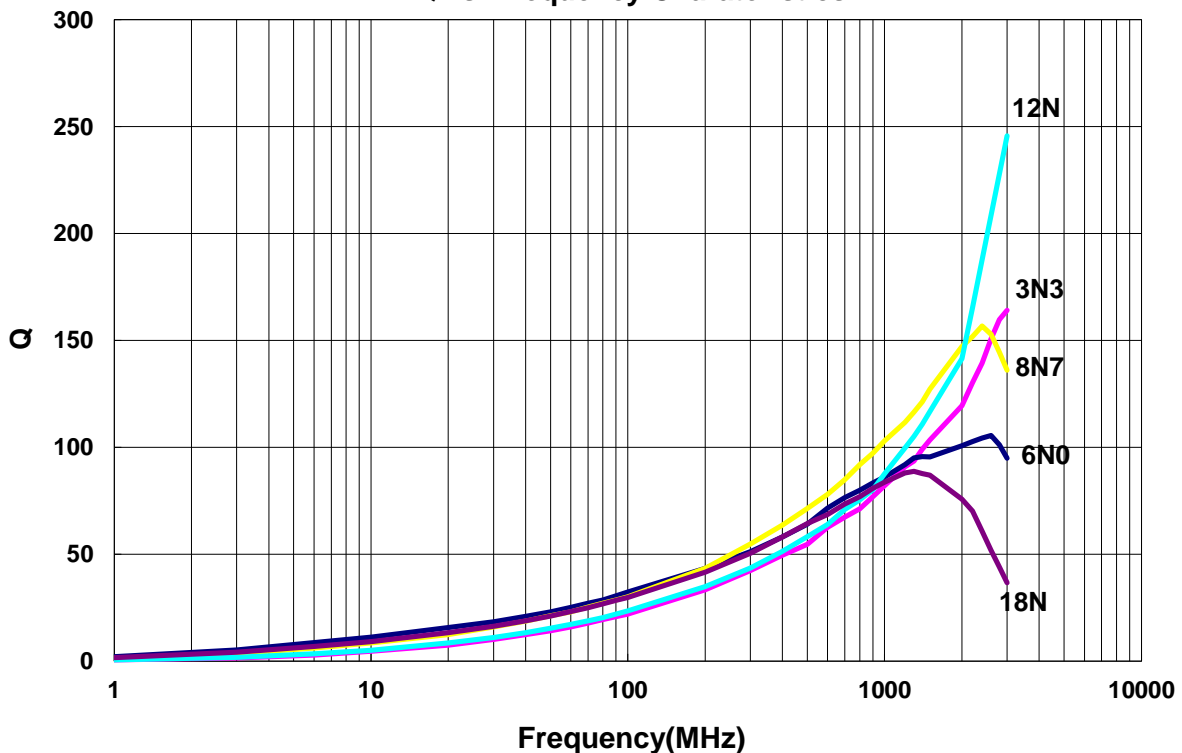

Chip Inductor AWHH Series

**Automotive
AEC-Q200**

■ Packaging

Tape Dimensions

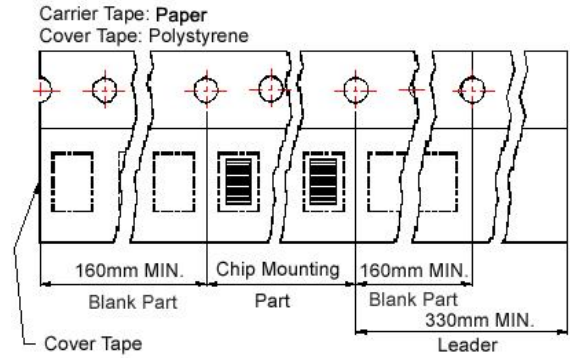
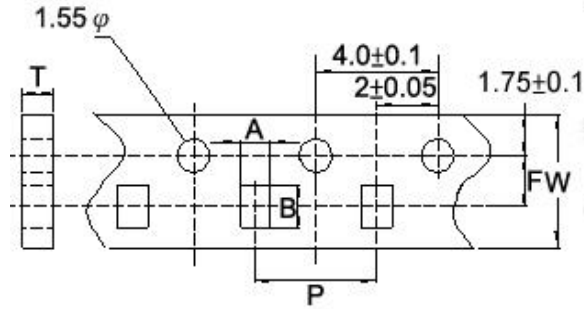

Reel Dimensions

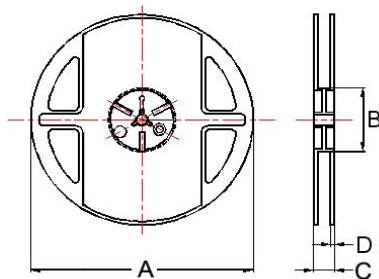

Dimensions in mm

| TYPE | Tape Dimensions | | | | | | Reel Dimensions | | | | Quantity PCS / Reel |
|--------------|-----------------|------|------|---|---|-----|-----------------|----|----|-----|------------------------|
| | A | B | T | W | P | F | A | B | C | D | |
| AWHH00161108 | 1.25 | 1.90 | 1.05 | 8 | 4 | 3.5 | 178 | 60 | 12 | 1.5 | 4000 |